

## Stainless Steel-T-Slot bolts

Accessory for profile systems

### SPECIFICATION

Stainless Steel AISI 304

### INFORMATION

T-Slot bolts GN 505.5 can be inserted vertically into the slot. During tightening, the bolt is forced into the crosswise position and thus anchored in the slot. Conversely, the bolt is turned back during loosening and can then be removed.

The clamping face of the bolt is serrated to ensure that the eloxal coating is broken up to establish a good electrical contact.

T-Slot bolts are made from a single piece or from two connected pieces.

### TECHNICAL INFORMATION

- Stainless Steel characteristics (see page A26)

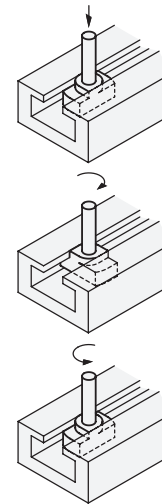
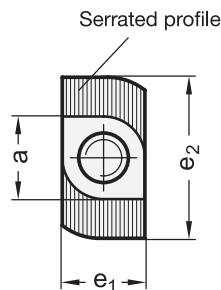
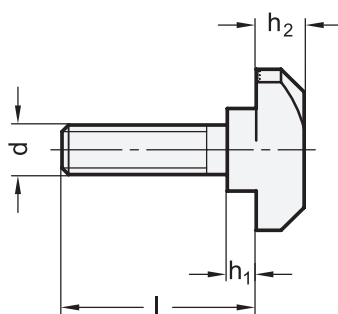

### GN 505.5

STAINLESS STEEL

Description	a -0.1/-0.6	d	l	h1	h2	e1	e2	⚖
GN 505.5-8-M6-20-1.6	8	M6	20	1.6-0.6	5 ±1.0	7.9-0.5	16 +0.5/-1.0	8
GN 505.5-8-M6-25-1.6	8	M6	25	1.6-0.6	5 ±1.0	7.9-0.5	16 +0.5/-1.0	5
GN 505.5-8-M6-30-1.6	8	M6	30	1.6-0.6	5 ±1.0	7.9-0.5	16 +0.5/-1.0	10
GN 505.5-8-M6-40-1.6	8	M6	40	1.6-0.6	5 ±1.0	7.9-0.5	16 +0.5/-1.0	10
GN 505.5-8-M6-60-1.6	8	M6	60	1.6-0.6	5 ±1.0	7.9-0.5	16 +0.5/-1.0	15
GN 505.5-10-M6-20-3.5	10	M6	20	3.5-1.0	6.5-1.5	10 0/-2.5	19 +0.5/-2.0	10
GN 505.5-10-M6-25-3.5	10	M6	25	3.5-1.0	6.5-1.5	10 0/-2.5	19 +0.5/-2.0	10
GN 505.5-10-M6-30-3.5	10	M6	30	3.5-1.0	6.5-1.5	10 0/-2.5	19 +0.5/-2.0	15
GN 505.5-10-M6-40-3.5	10	M6	40	3.5-1.0	6.5-1.5	10 0/-2.5	19 +0.5/-2.0	17
GN 505.5-10-M6-60-3.5	10	M6	60	3.5-1.0	6.5-1.5	10 0/-2.5	19 +0.5/-2.0	18
GN 505.5-10-M8-20-3.5	10	M8	20	3.5-1.0	6.5-1.5	10 0/-2.5	19 +0.5/-2.0	10
GN 505.5-10-M8-25-3.5	10	M8	25	3.5-1.0	6.5-1.5	10 0/-2.5	19 +0.5/-2.0	15